

Product News

NO.24
04E

YUKEN KOGYO CO., LTD.

Product Planning Office
4-4-34, Kamitsuchidana-Naka,
Ayase, Kanagawa Pref.,
252-1113, JAPAN
Tel. +81-467-68-4100
Fax. +81-467-77-3115



"CJT 3.5 MPa" Series Hydraulic Cylinders "CJT" Series Hydraulic Cylinders with Proximity Switch Cushion Adjusting Valve Notification of change

The cushion adjusting valve has been changed for the purpose of improving the quality of the subject hydraulic cylinders.

The design numbers of the current models (including 30** special design products) will remain unchanged.

■Series Numbers

CJT35 / CJT35L

■Changes

(1) The structure of the cushion adjustment valve is changed as shown in the diagram below.

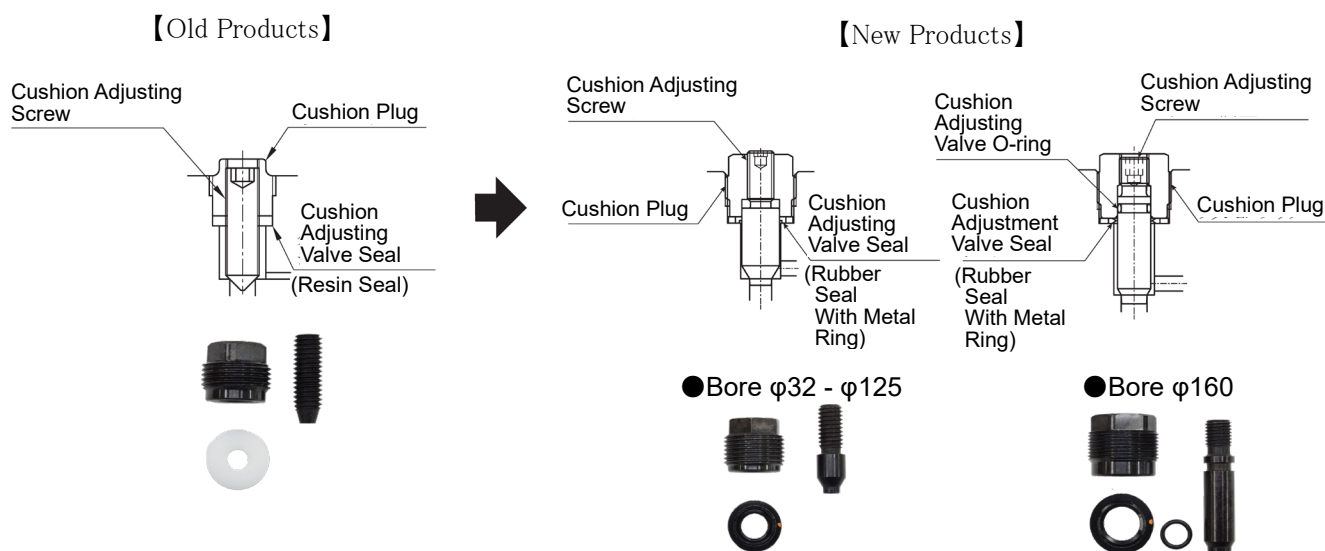

(2) The cushion adjustment valve seal will be changed from fluoroplastic (TF) to nitrile hydride rubber with metal ring (CX).

The check valve seal will also be changed to nitrile hydride rubber with metal ring (CR to CX)

- (3) The height of the adjusting screw of the cushion adjusting valve has changed, resulting in a change in the protrusion length. See drawings below.

Cylinder Bore	A		B	
	Old	New	Old	New
φ32	7	8	3.5	4.5
φ40	7	8	3.5	4.5
φ50	7	8	3	4.5
φ63	10	11	4	7
φ80	10	11	4	7
φ100	11	13	4	8.5
φ125	11	13	4	8.5
φ160	13	17	5	6.5

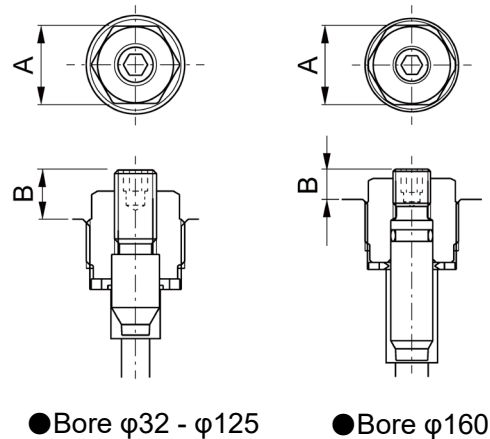

- (4) The maximum catalog value (T) of the old product is 5 mm, whereas for the new product it is stated as 10 mm max.

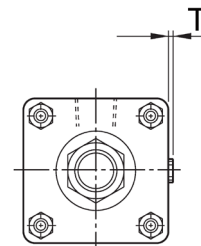

■ Interchangeability

- (1) Cushion adjustment valve: old and new products are interchangeable.
 (2) Seals for cushion adjustment valves: not interchangeable as old and new products differ.

Cushion Adjustment Valve Seal	Nitrile Hydride Rubber with Metal Ring	Fluoroplastic
New	Usable	Unusable
Old	Unusable	Usable

■List of Seals

Series	Item			⑧		⑨	⑩
	Cylinder Bore	Seal Kit Model Numbers	Name	Cushion Valve Seal		O-Ring for Cushion Valve Seal	Check Valve Seal
				New	Old		
			Material	Nitrile Hydride Rubber with Metal Ring	Fluoroplastic	Nitrile Hydride Rubber	Nitrile Hydride Rubber with Metal Ring
			Qty.	2	2	2	4
CJT35 (Without Switch)	φ32	KS-CJT35-32S-30		CX-8H	TF-8	—	CX-8H
	φ40	KS-CJT35-40S-30		CX-8H	TF-8	—	CX-8H
	φ50	KS-CJT35-50S-30		CX-8H	TF-8	—	CX-8H
	φ63	KS-CJT35-63S-30		CX-12H	TF-12	—	CX-12H
	φ80	KS-CJT35-80S-30		CX-12H	TF-12	—	CX-12H
	φ100	KS-CJT35-100S-30		CX-14H	TF-14	—	CX-14H
	φ125	KS-CJT35-125S-30		CX-14H	TF-14	—	CX-14H
	φ160	KS-CJT35-160S-30		CR-18H	TF-18	S-7	CR-18H
CJT35L (With Switch)	φ32	KS-CJT35L-32S-30		CX-8H	TF-8	—	CX-8H
	φ40	KS-CJT35L-40S-30		CX-8H	TF-8	—	CX-8H
	φ50	KS-CJT35L-50S-30		CX-8H	TF-8	—	CX-8H
	φ63	KS-CJT35L-63S-30		CX-12H	TF-12	—	CX-12H
	φ80	KS-CJT35L-80S-30		CX-12H	TF-12	—	CX-12H
	φ100	KS-CJT35L-100S-30		CX-14H	TF-14	—	CX-14H

★The quantity indicates the quantity for one unit when cushioned on both sides.

(1) The seal kit contains cushion valve seals (⑧) for new and old products, [φ160 kit also includes an O-ring for the cushion valve].

When replacing the cushion valve seal, check whether the cushion adjustment valve is new or old, then select and use the correct cushion valve seal.

(2) When installing the cushion valve seal (⑧) and check valve seal (⑩), please note that they have direction.

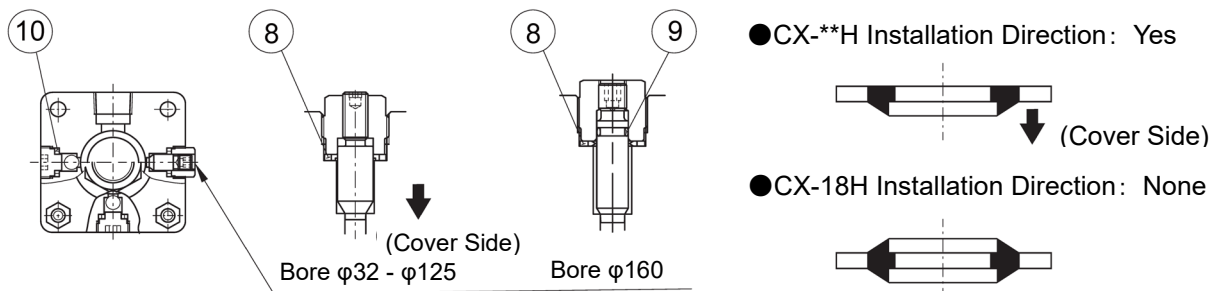

■Timing of Release

Starting with July shipments (Including Seal Kit)